

STANDARD C23

PHOTOELECTRIC SENSORS

ADVANTAGES

- ✓ First-class sensing ranges
- ✓ Small plastic housing, 20 mm x 30 mm x 10 mm
- ✓ Excellent background suppression characteristics with pinpoint LED
- ✓  **IO-Link** interface available on PNP types
- ✓ Mutual interference immunity
- ✓ Versions available with stability alarm as second output
- ✓ Enclosure rating IP67, Ecolab approved
- ✓ Versatile mounting brackets for ease of installation

WIRING DIAGRAMS

PNP or NPN, 1 output



PNP or NPN, 2 outputs

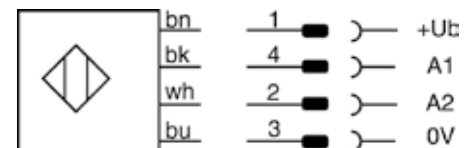

OVERVIEW	C23
Housing material	ABS / PMMA
Degree of protection	IP 67
Supply voltage range	10 ... 30 VDC
Ambient temperature range	-25 ... +65°C / -13 ... +149 °F
Output current	≤ 100 mA
Compatible mounting brackets	See pages 296-298

C23 SERIES



C23

HOUSING SIZE MM

□ 20 X 30 X 10

□ 20 X 30 X 10

OPERATING PRINCIPLE

DIFFUSE SENSOR WITH BACKGROUND SUPPRESSION

DIFFUSE SENSOR WITH BACKGROUND SUPPRESSION

SENSING RANGE MM

300

300

Inductive

PHOTOELECTRIC

Photoelectric



Safety

RFID

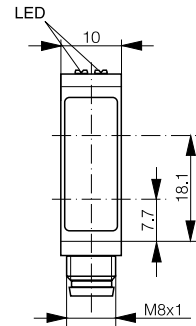
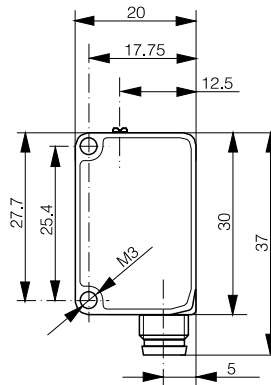

Connectivity

Accessories

DATA

IO-Link

IO-Link

Light source

Red pinpoint LED 640 nm

Red pinpoint LED 640 nm

Switching frequency (normal mode)

≤ 1000 Hz

≤ 1000 Hz

Setup

Potentiometer

Teach button or IO-Link

PNP Light-ON

LHR-C23PA-PMS-403

LHR-C23PA-TMS-403

PNP Light-ON + Dark-ON

LHR-C23PA-PMS-603

LHR-C23PA-TMS-603

PNP Light-ON + stability alarm

LHR-C23PA-PMS-60C

LHR-C23PA-TMS-60C

NPN Light-ON

LHR-C23PA-PMS-301

LHR-C23PA-TMS-301

NPN Light-ON + Dark-ON

LHR-C23PA-PMS-101

LHR-C23PA-TMS-101

NPN Light-ON + stability alarm

LHR-C23PA-PMS-10A

LHR-C23PA-TMS-10A

Other types available

Cable version

Cable version

Glossary

Index

STANDARD

HOUSING SIZE MM

□ 20 X 30 X 10

□ 20 X 30 X 10

OPERATING PRINCIPLE

DIFFUSE SENSOR

DIFFUSE SENSOR

SENSING RANGE MM

1500

1500

PHOTOELECTRIC

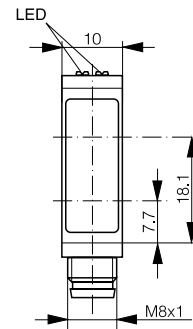
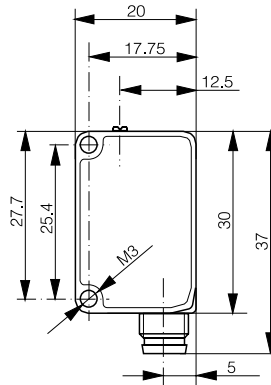

DATA

IO-Link

IO-Link

Light source

Red LED 630 nm

Red LED 630 nm

Switching frequency (normal mode)

≤ 1500 Hz

≤ 1500 Hz

Setup

Potentiometer

IO-Link

PNP Light-ON

LTR-C23PA-PMS-403

LTR-C23PA-NMS-403

PNP Light-ON + Dark-ON

LTR-C23PA-PMS-603

PNP Light-ON + stability alarm

LTR-C23PA-PMS-60C

NPN Light-ON

LTR-C23PA-PMS-301

NPN Light-ON + Dark-ON

LTR-C23PA-PMS-101

NPN Light-ON + stability alarm

LTR-C23PA-PMS-104

Other types available

Cable version

Cable version

C23 SERIES



C23

HOUSING SIZE MM	□ 20 X 30 X 10	□ 20 X 30 X 10
OPERATING PRINCIPLE	REFLEX SENSOR	THROUGH-BEAM SENSOR
SENSING RANGE MM	8000	30,000

Inductive



Photoelectric

Safety

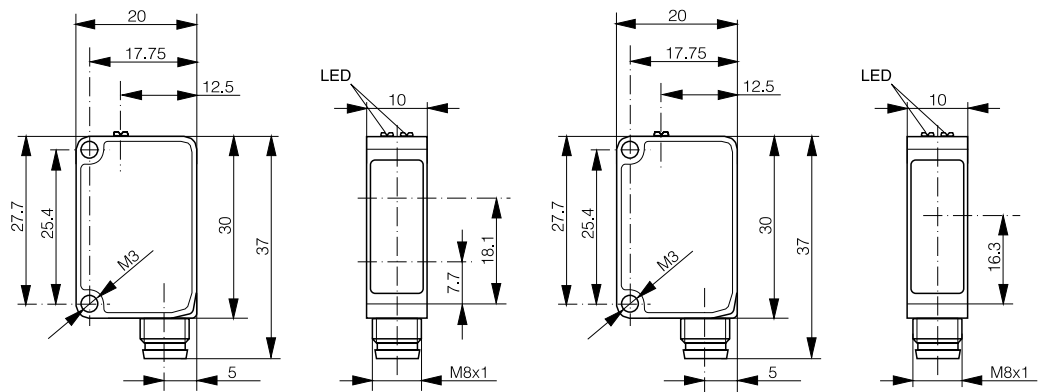

RFID

Connectivity

Accessories

DATA	IO-Link	IO-Link
Light source	LED red polarized 630 nm	LED red polarized 630 nm
Switching frequency (normal mode)	≤ 1500 Hz	≤ 1000 Hz
Setup	IO-Link	IO-Link
Emitter		LLR-C23PA-NMS-400
PNP Dark-ON	LRR-C23PA-NMS-404	LLR-C23PA-NMS-404
PNP Light-ON + Dark-ON	LRR-C23PA-NMS-603	LLR-C23PA-NMS-603
PNP Dark-ON + stability alarm	LRR-C23PA-NMS-60D	LLR-C23PA-NMS-60D
NPN Dark-ON	LRR-C23PA-NMS-302	LLR-C23PA-NMS-302
NPN Light-ON + Dark-ON	LRR-C23PA-NMS-101	LLR-C23PA-NMS-101
NPN Dark-ON + stability alarm	LRR-C23PA-NMS-10B	LLR-C23PA-NMS-10B
Other types available	Cable version	Cable version

Glossary

Index