

BASIC

| CLASSICS | CLASSICS | CLASSICS | CLASSICS | FULL INOX |
|----------|----------|----------|----------|-----------|
| M12 | M12 | M12 | M12 | M12 |
| 2 | 2 | 2 | 2 | 3 |

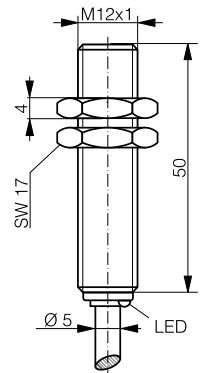
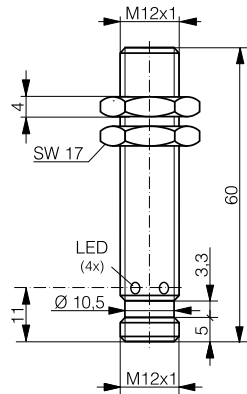
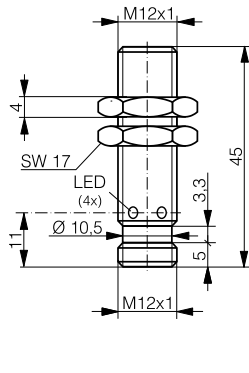
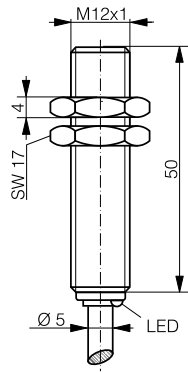
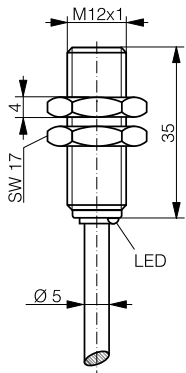

| IO-Link | IO-Link | IO-Link | IO-Link | IO-Link |
|------------------------------|------------------------------|------------------------------|------------------------------|------------------------------|
| Nickel-plated brass | Nickel-plated brass | Nickel-plated brass | Nickel-plated brass | Stainless steel V2A |
| PVC cable | PVC cable | Connector S12 | Connector S12 | PUR cable |
| IP 67 | IP 67 | IP 67 | IP 67 | IP 68 |
| Embeddable | Embeddable | Embeddable | Embeddable | Embeddable |
| 3000 Hz | 3000 Hz | 3000 Hz | 3000 Hz | 100 Hz |
| 10 ... 30 VDC | 10 ... 30 VDC | 10 ... 30 VDC | 10 ... 30 VDC | 10 ... 30 VDC |
| -25 ... +70°C/-13 ... +158°F | -25 ... +70°C/-13 ... +158°F | -25 ... +70°C/-13 ... +158°F | -25 ... +70°C/-13 ... +158°F | -25 ... +70°C/-13 ... +158°F |
| ≤ 200 mA | ≤ 200 mA | ≤ 200 mA | ≤ 200 mA | ≤ 200 mA |
| DW-AD-603-M12-120 | DW-AD-603-M12 | DW-AS-603-M12-120 | DW-AS-603-M12 | DW-AD-703-M12-BAS |
| DW-AD-601-M12-120 | DW-AD-601-M12 | DW-AS-601-M12-120 | DW-AS-601-M12 | DW-AD-701-M12-BAS |
| PNP NC, NPN NC | PNP NC, NPN NC | PNP NC, NPN NC | PNP NC, NPN NC | |

Inductive

Photoelectric

Safety

RFID

Connectivity

Accessories

Glossary

Index

BASIC

INDUCTIVE

| FAMILY | FULL INOX | CLASSICS | CLASSICS | CLASSICS |
|-----------------------|-----------|----------|----------|----------|
| HOUSING SIZE | M12 | M12 | M12 | M12 |
| OPERATING DISTANCE MM | 3 | 4 | 4 | 4 |

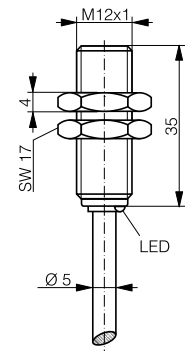
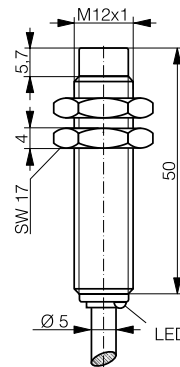
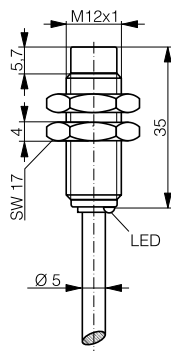
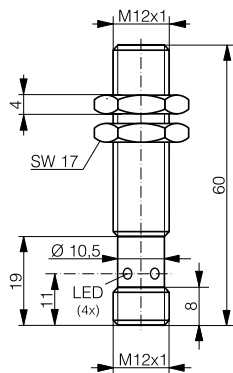

| DATA | IO-Link | IO-Link | IO-Link | IO-Link |
|---------------------------|--------------------------|--------------------------|--------------------------|--------------------------|
| Housing material | Stainless steel V2A | Nickel-plated brass | Nickel-plated brass | Nickel-plated brass |
| Connection | Connector S12 | PVC cable | PVC cable | PVC cable |
| Degree of protection | IP 68 & IP 69K | IP 67 | IP 67 | IP 67 |
| Mounting | Embeddable | Non-embeddable | Non-embeddable | Embeddable |
| Max. switching frequency | 100 Hz | 2000 Hz | 2000 Hz | 2500 Hz |
| Supply voltage range | 10 ... 30 VDC | 10 ... 30 VDC | 10 ... 30 VDC | 10 ... 30 VDC |
| Ambient temperature range | -25...+70°C/-13...+158°F | -25...+70°C/-13...+158°F | -25...+70°C/-13...+158°F | -25...+70°C/-13...+158°F |
| Output current | ≤ 200 mA | ≤ 200 mA | ≤ 200 mA | ≤ 200 mA |
| PNP NO | DW-AS-703-M12-BAS | DW-AD-613-M12-120 | DW-AD-613-M12 | DW-AD-623-M12-120 |
| NPN NO | DW-AS-701-M12-BAS | DW-AD-611-M12-120 | DW-AD-611-M12 | DW-AD-621-M12-120 |
| Other types available | | PNP NC, NPN NC | PNP NC, NPN NC | PNP NC, NPN NC |

BASIC

| | | | |
|----------|----------|----------|----------|
| CLASSICS | CLASSICS | CLASSICS | CLASSICS |
| M12 | M12 | M12 | M12 |
| 4 | 4 | 4 | 4 |

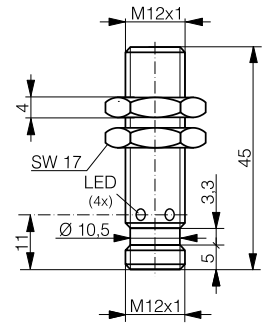
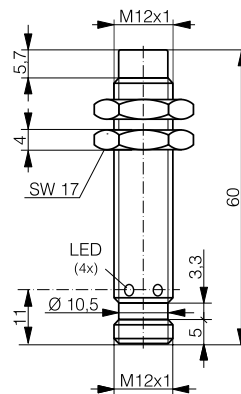
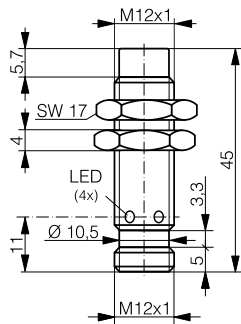
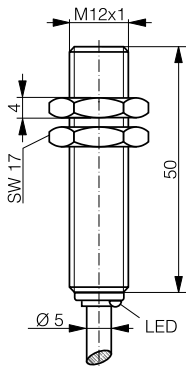

| IO-Link | IO-Link | IO-Link | IO-Link |
|--------------------------------|--------------------------------|--------------------------------|--------------------------------|
| Nickel-plated brass | Nickel-plated brass | Nickel-plated brass | Nickel-plated brass |
| PVC cable | Connector S12 | Connector S12 | Connector S12 |
| IP 67 | IP 67 | IP 67 | IP 67 |
| Embeddable | Non-embeddable | Non-embeddable | Embeddable |
| 2500 Hz | 2000 Hz | 2000 Hz | 2500 Hz |
| 10 ... 30 VDC | 10 ... 30 VDC | 10 ... 30 VDC | 10 ... 30 VDC |
| -25 ... +70°C / -13 ... +158°F | -25 ... +70°C / -13 ... +158°F | -25 ... +70°C / -13 ... +158°F | -25 ... +70°C / -13 ... +158°F |
| ≤ 200 mA | ≤ 200 mA | ≤ 200 mA | ≤ 200 mA |
| DW-AD-623-M12 | DW-AS-613-M12-120 | DW-AS-613-M12 | DW-AS-623-M12-120 |
| DW-AD-621-M12 | DW-AS-611-M12-120 | DW-AS-611-M12 | DW-AS-621-M12-120 |
| PNP NC, NPN NC | PNP NC, NPN NC | PNP NC, NPN NC | PNP NC, NPN NC |

Inductive

Photoelectric

Safety

RFID

Connectivity

Accessories

Glossary

Index

BASIC

INDUCTIVE

| FAMILY | CLASSICS | EXTRA DISTANCE | EXTRA DISTANCE |
|-----------------------|----------|----------------|----------------|
| HOUSING SIZE | M12 | M12 | M12 |
| OPERATING DISTANCE MM | 4 | 6 | 6 |

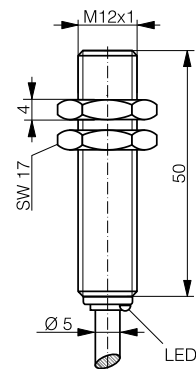
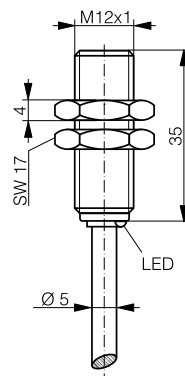
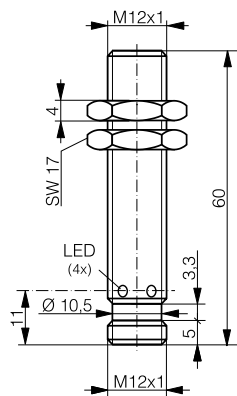

* IO-Link available from Q4/18

| DATA | IO-Link | * IO-Link | * IO-Link |
|---------------------------|--------------------------------|--------------------------------|--------------------------------|
| Housing material | Nickel-plated brass | Chrome-plated brass | Chrome-plated brass |
| Connection | Connector S12 | PVC cable | PVC cable |
| Degree of protection | IP 67 | IP 67 | IP 67 |
| Mounting | Embeddable | Quasi-embeddable | Quasi-embeddable |
| Max. switching frequency | 2500 Hz | 800 Hz | 800 Hz |
| Supply voltage range | 10 ... 30 VDC | 10 ... 30 VDC | 10 ... 30 VDC |
| Ambient temperature range | -25 ... +70°C / -13 ... +158°F | -25 ... +70°C / -13 ... +158°F | -25 ... +70°C / -13 ... +158°F |
| Output current | ≤ 200 mA | ≤ 200 mA | ≤ 200 mA |
| PNP NO | DW-AS-623-M12 | DW-AD-503-M12-120 | DW-AD-503-M12 |
| NPN NO | DW-AS-621-M12 | DW-AD-501-M12-120 | DW-AD-501-M12 |
| PNP NC | DW-AS-624-M12 | | |
| Other types available | NPN NC | PNP NC, NPN NC | PNP NC, NPN NC |

BASIC

| EXTRA DISTANCE | EXTRA DISTANCE | CLASSICS | CLASSICS |
|----------------|----------------|----------|----------|
| M12 | M12 | M12 | M12 |
| 6 | 6 | 8 | 8 |

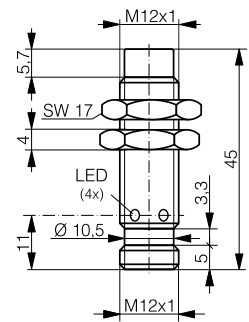
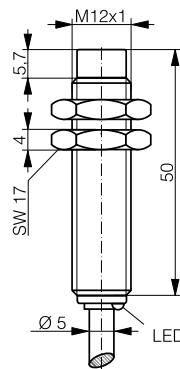
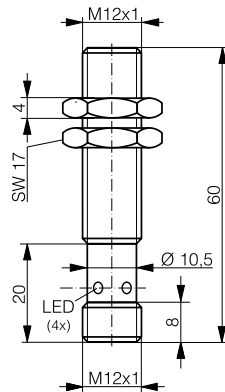
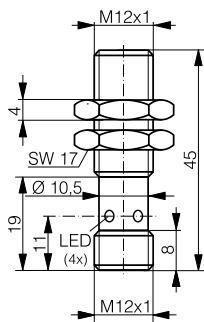

| * IO-Link | * IO-Link | IO-Link | IO-Link |
|--------------------------------|--------------------------------|--------------------------------|--------------------------------|
| Chrome-plated brass | Chrome-plated brass | Nickel-plated brass | Nickel-plated brass |
| Connector S12 | Connector S12 | PVC cable | Connector S12 |
| IP 67 | IP 67 | IP 67 | IP 67 |
| Quasi-embeddable | Quasi-embeddable | Non-embeddable | Non-embeddable |
| 800 Hz | 800 Hz | 1400 Hz | 1400 Hz |
| 10 ... 30 VDC | 10 ... 30 VDC | 10 ... 30 VDC | 10 ... 30 VDC |
| -25 ... +70°C / -13 ... +158°F | -25 ... +70°C / -13 ... +158°F | -25 ... +70°C / -13 ... +158°F | -25 ... +70°C / -13 ... +158°F |
| ≤ 200 mA | ≤ 200 mA | ≤ 200 mA | ≤ 200 mA |
| DW-AS-503-M12-120 | DW-AS-503-M12 | DW-AD-633-M12 | DW-AS-633-M12-120 |
| DW-AS-501-M12-120 | DW-AS-501-M12 | DW-AD-631-M12 | DW-AS-631-M12-120 |
| | DW-AS-504-M12 | DW-AD-634-M12 | DW-AS-634-M12-120 |
| PNP NC, NPN NC | NPN NC | NPN NC, length 35 mm | NPN NC, length 60 mm |

Inductive

Photoelectric

Safety

RFID

Connectivity

Accessories

Glossary

Index

BASIC

| EXTRA DISTANCE | EXTRA DISTANCE | EXTRA DISTANCE | EXTRA DISTANCE |
|----------------|----------------|----------------|----------------|
| M12 | M12 | M12 | M12 |
| 8 | 10 | 10 | 10 |

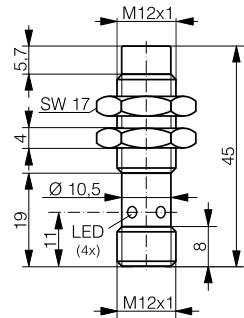
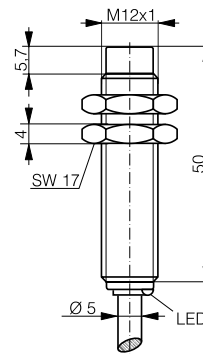
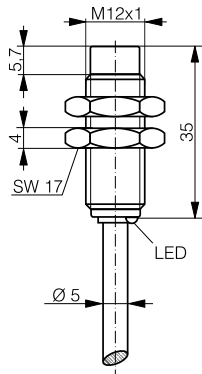
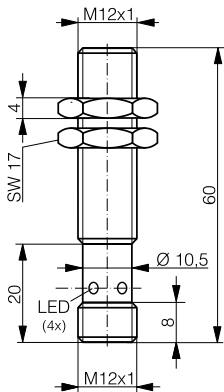

| * IO-Link | * IO-Link | * IO-Link | * IO-Link |
|--------------------------------|--------------------------------|--------------------------------|--------------------------------|
| Chrome-plated brass | Chrome-plated brass | Chrome-plated brass | Chrome-plated brass |
| Connector S12 | PVC cable | PVC cable | Connector S12 |
| IP 67 | IP 67 | IP 67 | IP 67 |
| Quasi-embeddable | Non-embeddable | Non-embeddable | Non-embeddable |
| 400 Hz | 400 Hz | 400 Hz | 400 Hz |
| 10 ... 30 VDC | 10 ... 30 VDC | 10 ... 30 VDC | 10 ... 30 VDC |
| -25 ... +70°C / -13 ... +158°F | -25 ... +70°C / -13 ... +158°F | -25 ... +70°C / -13 ... +158°F | -25 ... +70°C / -13 ... +158°F |
| ≤ 200 mA | ≤ 200 mA | ≤ 200 mA | ≤ 200 mA |
| DW-AS-523-M12 | DW-AD-513-M12-120 | DW-AD-513-M12 | DW-AS-513-M12-120 |
| DW-AS-521-M12 | DW-AD-511-M12-120 | DW-AD-511-M12 | DW-AS-511-M12-120 |
| PNP NC, NPN NC | PNP NC, NPN NC | PNP NC, NPN NC | PNP NC, NPN NC |

Inductive

Photoelectric

Safety

RFID

Connectivity

Accessories

Glossary

Index